

THE *New* HARMAN & COLLINS 8R-100 MAGNETO

FEATURES

The 8R-100 Series HARMAN & COLLINS MAGNETO is the first complete all-new hi-performance magneto designed for V8 and Mercury racing engines. Ease of starting, rugged construction and simplicity of installation make this magneto ideal for commercial and industrial application.

Principal features of the 8R-100 are: A direct engine-connected, 8-pole rotor assembly eliminating all gearing with its attendant noise and wear. Eliminates the problem of synchronizing two four-cylinder magnetos for accurate firing sequences. Accuracy of firing in the 8R-100 is inherent and will remain unchanged for the life of the magneto due to the 8-lobe cam and breaker design.

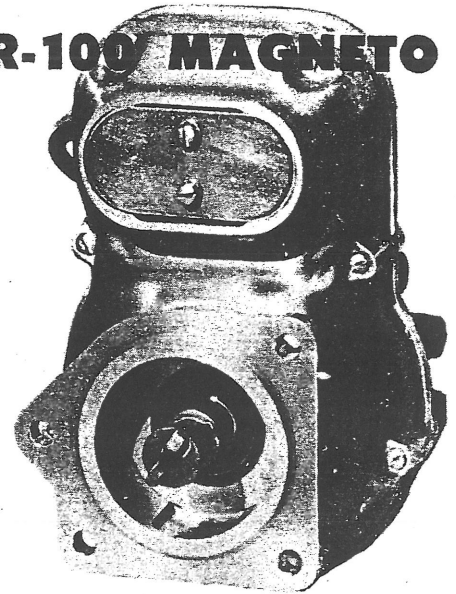

STARTING: Large diameter rotor with eight AL-NICO Magnets provides quick starting without the aid of an impulse coupling.

LONG LIFE: Assured by magneto running at $\frac{1}{2}$ engine speed. Rotor runs on high quality ball bearings, sealed and lubricated for life. Built in blower pulling air through dual filters keeps the magneto cool and free from dirt, also expels harmful oxide gases present in all ignition systems.

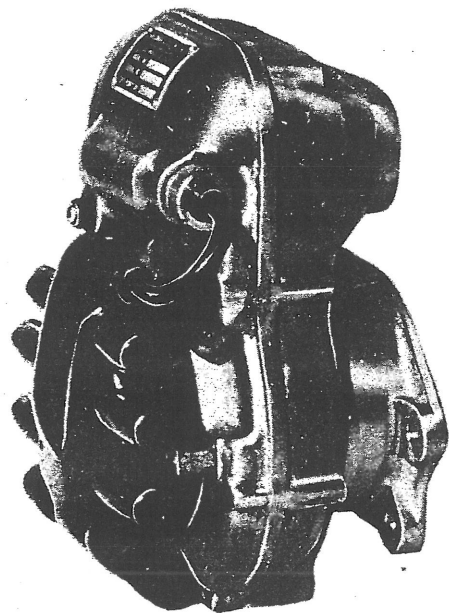

PERFORMANCE: The 8R-100 HARMAN & COLLINS Magneto has undergone rigid testing for over a year on many race cars and boats. Although new in design, the number of track and straightaway records already set by the 8R-100 proves its superiority over other types of ignition systems. Constant testing has proved the original design sound, few changes having been made since the original design was completed.

HARMAN & COLLINS

INCORPORATED

5552 ALHAMBRA AVENUE

• LOS ANGELES 32, CALIF. •

Phone CApitol 4610

Warranty

HARMAN & COLLINS, INCORPORATED warrants each 8R-100 Magneto to be free from defects in material and workmanship when used under conditions for which it is designed. Our obligation under this warranty is limited to making good at our factory, and at no other place, any part or parts which shall, within 90 days after delivery of each new Harman & Collins Magneto to the original purchaser, be returned to us with transportation charges prepaid, and which our examination shall disclose to our satisfaction to have been defective.

This warranty shall not apply if any part or parts of the magneto appears to have been subjected to misuse, abuse, neglect or accident, or if it has been repaired or altered outside of our factory, and our obligations do not include any labor charges for replacement of parts, adjustments or repair work.

We reserve the right to make changes and improvements without being obligated to make such changes gratis on magnetos previously built, and to make such changes at our discretion and without notice.

Any parts sent to us for replacement or servicing must have transportation charges prepaid and should have a tag attached showing serial number, model number, length of operation, and other pertinent data.

This warranty applies only to Harman & Collins Magnetos using genuine Harman & Collins parts.

Harman & Collins, Incorporated
5552 Alhambra Avenue • Los Angeles 32, California

Your 8R-100 MAGNETO HARMAN & COLLINS, INC.

INSTRUCTIONS

Your HARMAN & COLLINS MAGNETO is designed to give maximum service under severe operating conditions and normally requires no service other than to the breaker points.

1. Match RED index marks on the breaker plate and case.
2. A. Set points at .015 gap. (When replacing points use Harman & Collins Part No. 5056 or Delco Set No. 1871870). Spring tension should be 28 to 32 ounces when points are closed.
B. When it is necessary to clean and readjust contacts, Magneto timing to the engine should be rechecked and adjusted if necessary as noted in Paragraph 4 and 5.
3. When the magneto was assembled the coupling was marked to give 20 crankshaft degrees advance when the red marks are in alignment. (See Paragraph 2-8)
4. FOR FURTHER ADVANCE: (View from mounting flange)
(a) Fluid magneto SHAFT STILL.
(b) Rotate COUPLING CLOCKWISE on magneto shaft.
(c) Rotate TONGUE DRIVE COUNTER-CLOCKWISE in coupling.
(d) One loath rotation in each spline as above directed gives 1.8 degrees crankshaft timing change.
5. TO RETARD: Reverse the above instructions.

REPAIRS:

6. Whenever possible return to factory or authorized service station for repairs.
7. When corresponding or when ordering parts use magneto model number, serial number, and part number.

LUBRICATION:

8. A. The only lubricating points in the magneto is the felt wiper No. 5057 and the breaker axle bearing. The felt, which lubricates the breaker arm at the point of contact with the cam, should be replaced whenever it is necessary to replace the points. If the felt wiper becomes dry, place ONE DROP ONLY of SAE 50 oil on it. Keep oil and grease away from the contact surfaces. Breaker axle bearing may be lubricated with a heavy bearing grease, or Bosch High Temperature Magneto Grease.
B. The Ball Bearings of this Magneto are packed with high melting point grease and should require no further lubrication. If it is found necessary to lubricate bearings, use HARMAN AND COLLINS GREASE No. 5098.

CAUTION:

9. DO NOT CONNECT TO IGNITION SWITCH OR BATTERY LEAD.
10. When testing, do not use an air gap in excess of $\frac{3}{16}$ inch, or 10 mm, unless under conditions approved by the factory, or serious damage to the insulation may result.
11. Spark plugs should be spaced from .015 to .025 gap.
12. Gasket No. 5067 must be used at all times under Distributor Cap No. 5866.
13. Inside of Distributor Cap is coated with Scintilla Wax Compound No. 72 to prevent internal arcing. During overhaul clean cap thoroughly and apply light coat of wax.
14. Air inlet filters and passages should be cleaned periodically to maintain proper cooling of Magneto.

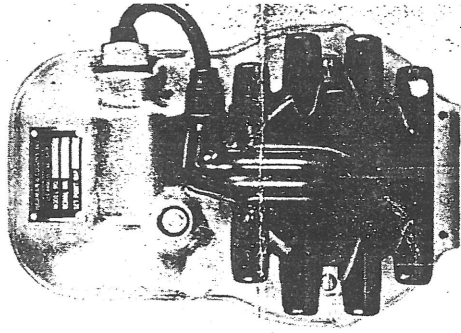

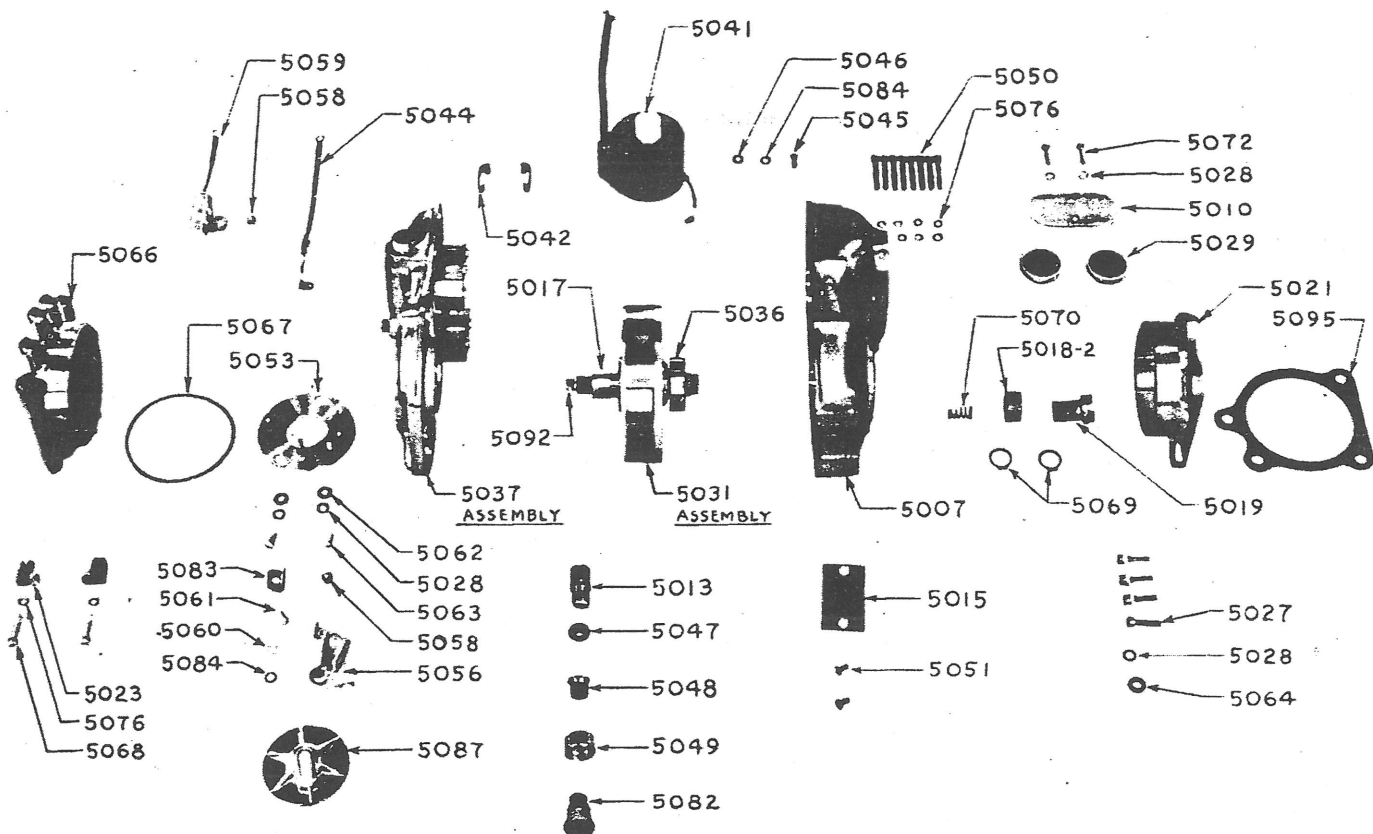

HOW TO ORDER PARTS

1. Order by Part Number. If any confusion exists between part number and part name, the part number will be used in filling your order.
2. Whenever possible, mention the serial number and model number of the magneto for which the parts are intended.
3. Unless the method of shipment is definitely specified in your order, we will use our best judgment.
4. Do not send money with your order. Shipment will be made C.O.D. unless an application for an open account has been accepted.
5. Please print your name and address plainly on your order.

PARTS LIST

Parts and Sub-Assemblies as sold for replacement

5007	Housing Assembly—Rear	5050	Screw—Fillister Head (10-32x1-1/4)
5010	Plate—Filter Cover	5051	Screw—Flat Head (8-32x3/8)
5013	Bushing—Insulator	5053	Breaker Plate Assembly, Complete
5015	Plate—Air Vent	5056	Breaker Set
5017	Shaft—Magneto	5058	Screw—Fillister Head (8-32x3/16)
5018-1	Coupling—Vernier Drive—Long	5059	Condenser
5018-2	Coupling—Vernier Drive—Short	5060	Nut—Hex (8-32)
5019	Shaft—Coupling Drive	5061	Screw—Round Head (8-32x3/8)
5021	Flange—Magneto Mount	5062	Washer—Flat (No. 10)
5023	Clamp—Distributor Cap	5063	Screw—Fillister Head (10-32x3/8)
5027	Screw—Socket Head Cap (10-32x3/4)	5064	Washer—Flat (No. 10x1/2 ODx1/16)
5028	Washer—Lock (Shakeproof No. 1210)	5066	Cap—Distributor
5029	Disc—Filter	5067	Gasket—Distributor Cap
5031	Magnet Assembly, Complete	5068	Screw—Fillister Head Brass (10-32x7/8)
5035	Key—Woodruff (5-32x5/8)	5069	Ring—Snap
5036	Bearing—Ball	5070	Spring—Coupling Retaining
5037	Housing Assembly—Front	5072	Screw—Fillister Head (10-32x5/8)
5041	Coil Assembly, Complete	5076	Washer—Lock (No. 10)
5042	Clip—Coil Retaining	5082	Nipple—Secondary Lead
5044	Lead—Primary Wire Complete	5083	Insulator—Breaker Assembly
5045	Screw—Fillister Head (8-32x3/8)	5084	Washer—Plain Brass (No. 8)
5046	Washer—Lock (Shakeproof No. 1208)	5087	Rotor—Distributor
5047	Gromet—Rubber	5092	Insert—Rotor Drive
5048	Collar	5093	Ring—Snap
5049	Nut—High Tension Outlet Sleeve	5095	Gasket—Magneto Mounting

OUTLINE DRAWING MAGNETO MODEL 8R-100 SERIES

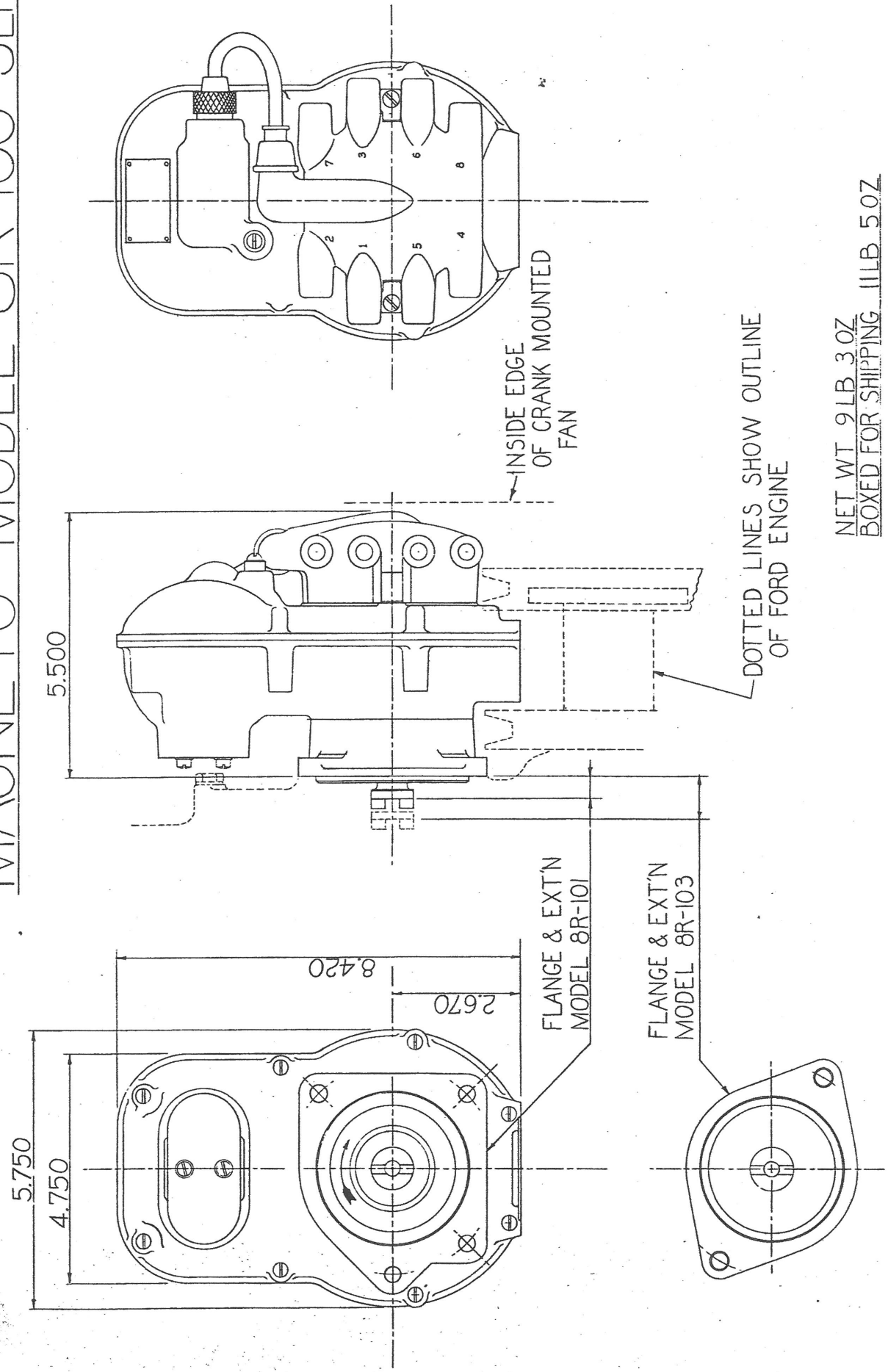

NET WT 9 LB 3 OZ
BOXED FOR SHIPPING 11LB 5 OZ

NEVER PAY 6% TO SELL

RE/MAX Team One

Bob Daniel, Realtor®

Serving O.C. Since 1973

(714) 968-4998

Paints DR2236P
Condenser DR60

HARMAN & Collins
MAG

Listing Commission Only 1%

Each Office is Independently Owned and Operated.